

The First Test of English

Text:

Hi, my name is Susan. I am 13 years old. I am a pupil at Wilson School. My school is large and beautiful. It is in London. We have 12 classrooms, a sports ground, 2 physics labs, 2 biology labs, a computer room and a canteen where we have lunch. We have a lovely schoolyard where we play. We study 12 subjects there like: maths, English, Arabic, history, geography...etc. We start lessons at 8 o'clock in the morning and we finish at 4 o'clock in the afternoon. All pupils here are nice and polite.



Part One: (14 pts)

A/ Reading Comprehension(07pts)

Activity one : Complete the table with information from the text (04pts).

| The school's name | City | Number of classrooms | Number of subjects |
|-------------------|-------|----------------------|--------------------|
| | | | |

Activity Two: Read the following statements and tick (✓) true or false (3pts)

| Statement | True | false |
|---|------|-------|
| 1- Susan's school has 1 physics lab. | | |
| 2- Pupils in Susan's school study 12 subjects. | | |
| 3- Lessons start at 4 o'clock in the afternoon. | | |

B/ Mastery of language (7pts)

Activity One: Complete the following sentences with 'from', 'to' or 'on' (3pts).

A: When do you study English?

B: I study English Sunday, 8: 00 a.m 9:00 and Thursday, 3:00 p.m
..... 4: 00 p.m.

Activity Two: Check the correct box(✓)(2pts):

- | | | |
|--------------------------|--------------------------|------------------------|
| I do | I don't | |
| <input type="checkbox"/> | <input type="checkbox"/> | chew gum in class. |
| <input type="checkbox"/> | <input type="checkbox"/> | listen to the teacher. |
| <input type="checkbox"/> | <input type="checkbox"/> | eat food in class. |
| <input type="checkbox"/> | <input type="checkbox"/> | respect my friends. |

Activity Three: Write the following words in the right box according to their vowel sound

pronunciation (2pts)

I - speak- read- my

| | |
|-----------------|---------------------|
| /ai/ h <u>i</u> | /i:/ gr <u>ee</u> n |
| | |
| | |

Part Two: Written Expression (6pts):

A new pupil arrived at the school. He wants to know about the location of the following places: **the sports ground, the physics lab and the canteen.** Follow the map and write the dialogue between you and the new pupil.

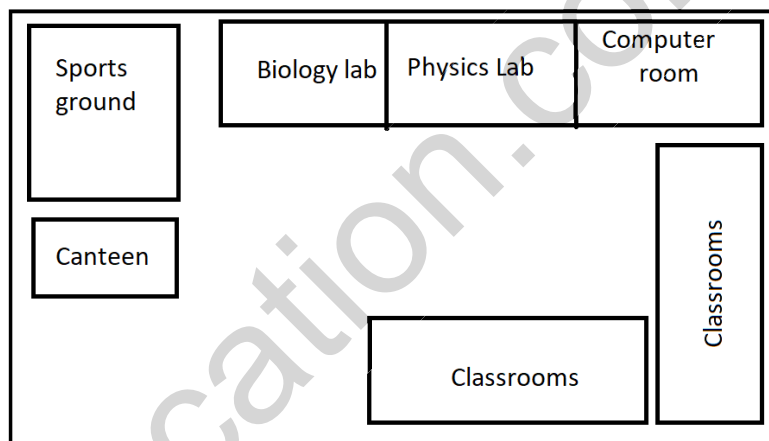

The new pupil: Excuse me, where is the sports ground?

You:

The new pupil:

You:

The new pupil:

You:

